

# FUME HOOD INSTALL SHEET 2 STEPS 6-9A

NOTE - ALL ELECTRICAL BOX MODEL #'S ARE FROM O-Z/GEDNEY MFG. "STEEL BOXES & COVERS"

**6**

STEP 6

1. CONNECT MAIN POWER TO HOOD. PRIOR TO DOING THIS MAKE SURE ALL CONNECTIONS ARE GOOD NO EXPOSED WIRES OR OPEN CONNECTIONS.
2. DROP CONNECTION TO "J" BOX LOCATION TYPICALLY LOCATED AT THE FUME HOOD BACK RIGHT HAND SIDE LOCATION. THE BOX IS SECURED TO THE FRAME BACK.
3. MAKE THE CONNECTION THEN TEST DUPLEX AND LIGHT FOR OPERATION. NOTE LIGHT BULBS ARE NOT PROVIDED THE CUSTOMER MUST PROVIDE. INSTALL BULBS AND TEST LIGHT.
4. TEST ALL OTHER ELECTRICAL DEVICES IF PROVIDED INCLUDING BLOWER AND ALARM SYSTEMS.

STD. "J" BOX #132AP1/2 OR EQUAL. FOR MORE CONNECTIONS ASK FOR #2G-5075 6"W. OR #3G-5075 8"W. BOX OR EQUALS

MAIN CONNECTION W/ POWER SINGLE SOURCE

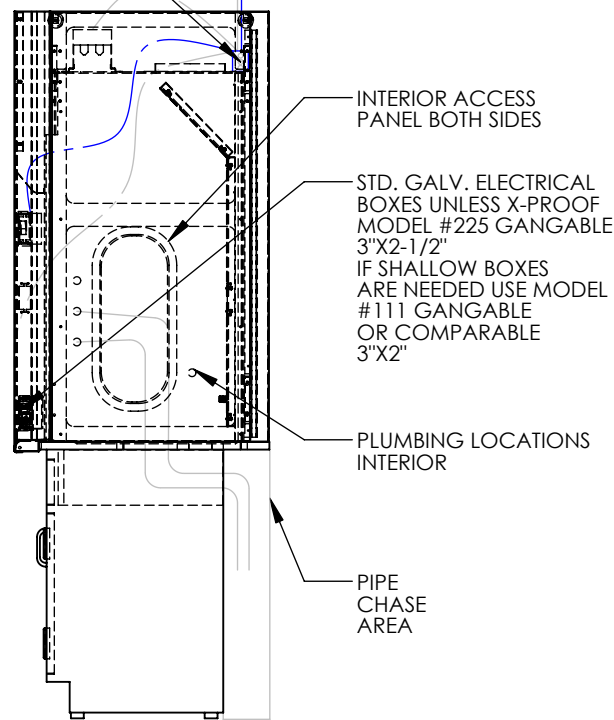

RUN HVAC DOWN TO FUME HOOD MAKE THE CONNECTION AS REQUIRED. ONCE COMPLETE CHECK FOR LEAKS AND SEAL.

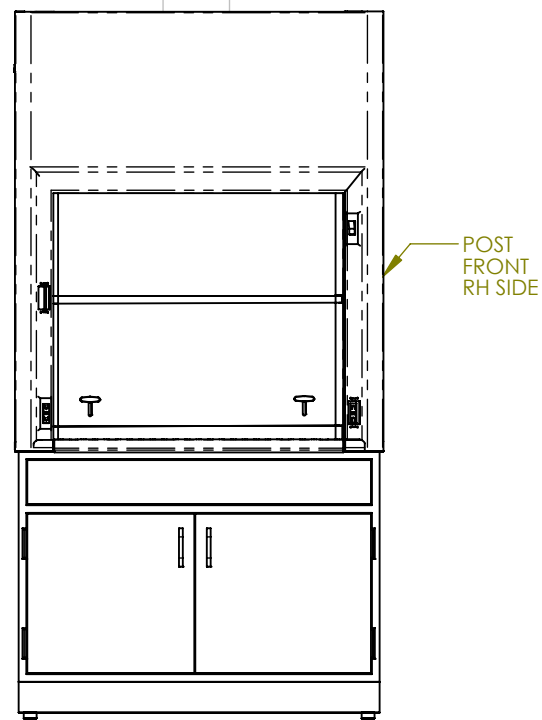

FRONT VIEW

SIDE PANEL

TYPICAL FLEX METAL CONDUIT OR HARD PIPE IF X-PROOF

CONNECT HVAC DUCTING COMPLETE

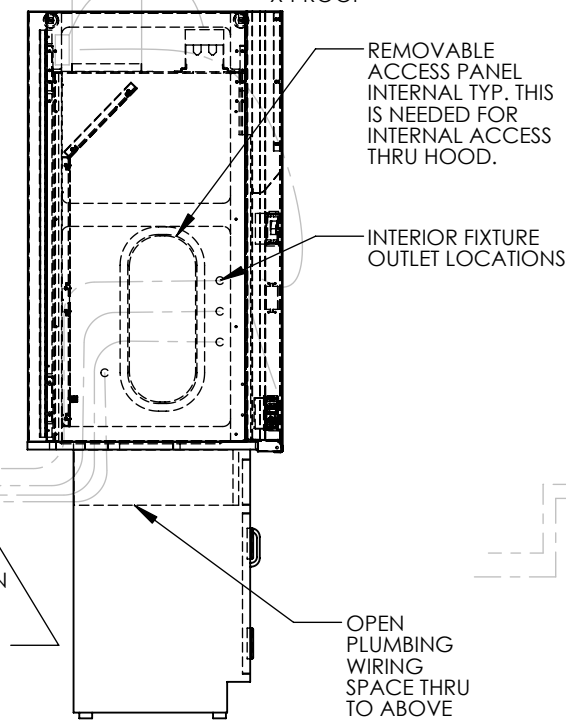

PIPING LOCATION IF PIPING FROM BELOW INTO FUME HOOD

OPEN PLUMBING WIRING SPACE THRU TO ABOVE CABINET

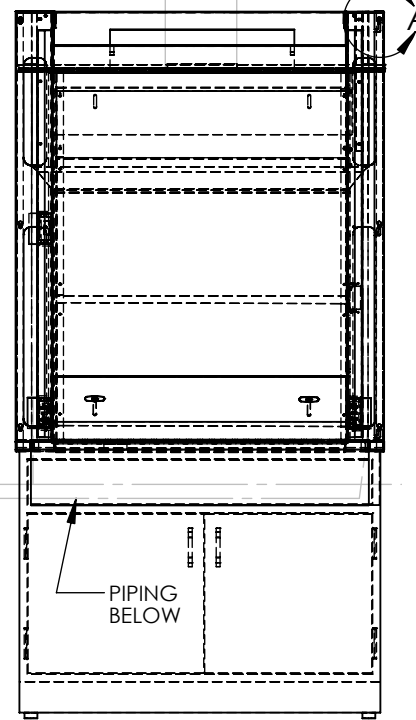

BACK VIEW

**8**

STEP 8 PLUMBING CONNECTIONS THIS PORTION OF THE INSTALL IS COMPLETED BY THE APPROPRIATE TRADE ONLY.

1. PLUMBING - RUN CONNECTIONS EITHER UP, DOWN FROM ABOVE, OR FROM THE BACK TO THE HOOD.
2. MAKE THE NEEDED CONNECTIONS BASED ON YOUR LOCAL CODE REQUIREMENTS.

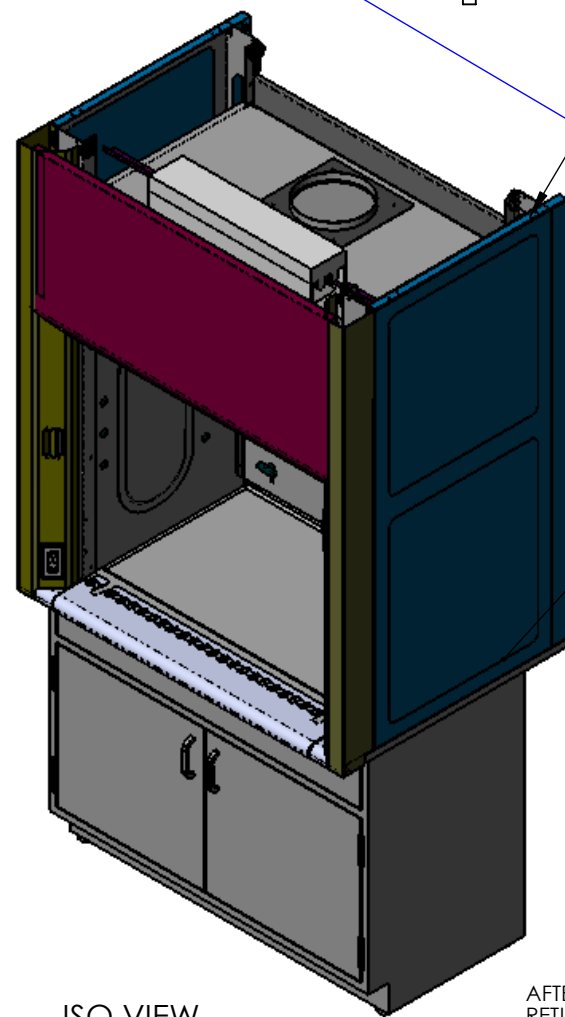

ISO VIEW

**9**

AFTER ALL CONNECTIONS HAVE BEEN MADE RETURN SIDE PANELS AND RE-INSTALL. AFTER COMPLETION RUN APPROPRIATE TESTS AS NEEDED TO COMPLETE CERTIFICATION.

DUCT CONNECTION MATERIAL IS DETERMINED BY APPLICATION SIZE IS ALSO DETERMINED BY MODEL OUR STANDARD CONNECTION IS ROUND W/ 1" H DUCT COLLAR TYPICAL.

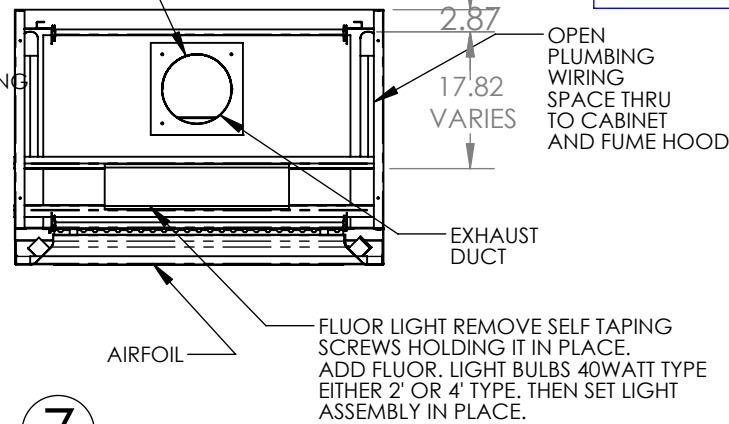

**7**

STEP 7 HVAC CONNECTIONS COMPLETE THIS PORTION IS COMPLETED BY THE APPROPRIATE TRADE ONLY.

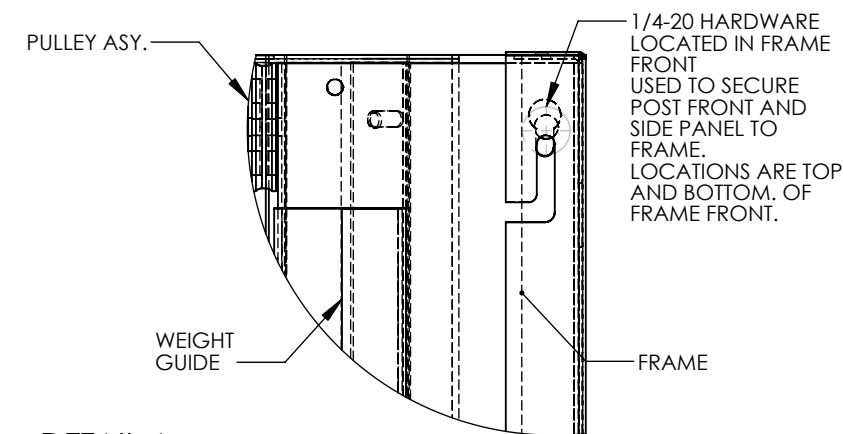

DETAIL A SCALE 1 : 3

**9A**

SIDE PANEL RE-INSTALL

1. RETURN 1/4-20 FRAME BOLT IN TOP OF FRAME FRONT / FRONT POST. MAKE SURE THE ASSEMBLY IS LOOSE.
2. SLIDE KEYWAYS IN THE BOTTOM FRAME / POST FRONT LOCATION. ALSO MAKE SURE THE SIDE PANEL BOTTOM CLIP IS PUSHED IN.
3. ONCE THE BOTTOM HAS SLIDE DOWN ABOUT AN 1/8 TO 1/4 THE TOP KEYWAY WILL SLIP IN. YOU CAN THEN PUSH THE SIDE PANEL ALL THE WAY DOWN. KNOW TIGHTEN ALL BOLTS.
4. LAST RETURN SELF TAPING SCREWS TO TOP QTY 4 AND YOU ARE COMPLETE.